

Kühlung	
Toleranz	e8
Beschichtung	TiN- α

HA HB HSC  







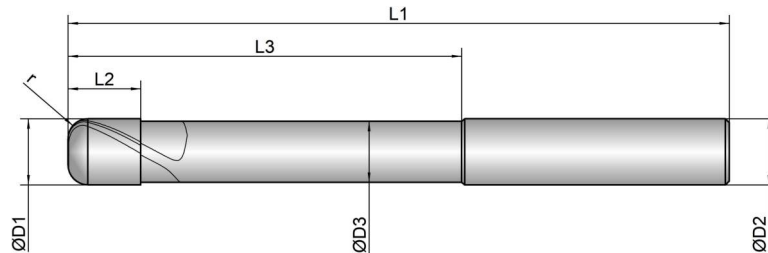

HA K202013

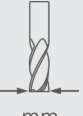
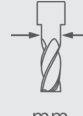

HB K202014



Stahl			Gehärteter Stahl				INOX (VA)	Guss	NE-Werkstoffe				Inconel	Abrasivmaterial		Titan
< 850 N/mm	< 1100 N/mm	< 1400 N/mm	< 55 HRC	< 60 HRC	< 67 HRC	< 70 HRC			Alu	Kupfer	Mg	Kunststoffe		CFK / GFK	Grafit	
									320				350			

K202013	K202014	D1	D3	L2	L3	L1	D2	z	r	°
		 mm Ø	 mm Ø	 mm	 mm	 mm	 mm Ø	 #	 mm	
3/0,3	-	3,0	2,7	4,0	32,0	75,0	3,0	2	0,30	30
4/0,3	-	4,0	3,7	5,0	36,0	75,0	4,0	2	0,30	30
5/0,3	-	5,0	4,6	6,0	40,0	75,0	5,0	2	0,30	30
6/0,3	6/0,3	6,0	5,5	7,0	44,0	80,0	6,0	2	0,30	30
6/1	6/1	6,0	5,5	7,0	44,0	80,0	6,0	2	1,00	30
6/2	6/2	6,0	5,5	7,0	44,0	80,0	6,0	2	2,00	30
8/0,3	8/0,3	8,0	7,4	9,0	54,0	100,0	8,0	2	0,30	30
8/1	8/1	8,0	7,4	9,0	54,0	100,0	8,0	2	1,00	30
8/2	8/2	8,0	7,4	9,0	54,0	100,0	8,0	2	2,00	30
10/0,3	10/0,3	10,0	9,2	11,0	60,0	100,0	10,0	2	0,30	30
10/1,5	10/1,5	10,0	9,2	11,0	60,0	100,0	10,0	2	1,50	30
10/3	10/3	10,0	9,2	11,0	60,0	100,0	10,0	2	3,00	30
12/0,5	12/0,5	12,0	11,0	12,0	75,0	120,0	12,0	2	0,50	30
12/1,5	12/1,5	12,0	11,0	12,0	75,0	120,0	12,0	2	1,50	30
12/4	12/4	12,0	11,0	12,0	75,0	120,0	12,0	2	4,00	30
16/1	16/1	16,0	15,0	16,0	92,0	150,0	16,0	2	1,00	30
16/2	16/2	16,0	15,0	16,0	92,0	150,0	16,0	2	2,00	30
16/5	16/5	16,0	15,0	16,0	92,0	150,0	16,0	2	5,00	30