

Kühlung	
Toleranz	e8
Beschichtung	TiAlN- α

HA HSC UNI

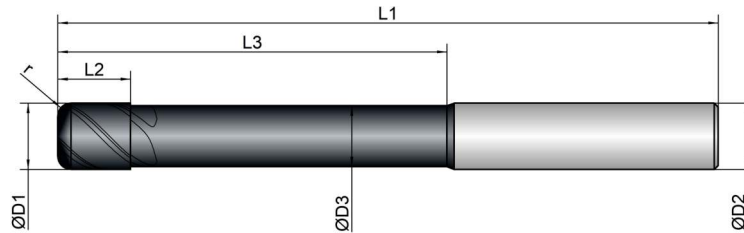









HA K202173

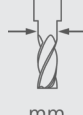

Stahl			Gehärteter Stahl				INOX (VA)	Guss	NE-Werkstoffe				Inconel	Abrasivmaterial		Titan
< 850 N/mm	< 1100 N/mm	< 1400 N/mm	< 55 HRC	< 60 HRC	< 67 HRC	< 70 HRC			Alu	Kupfer	Mg	Kunststoffe		CFK / GFK	Grafit	
120	80	70	40	35			85	95								

	D1	D3	L2	L3	L1	D2	z	r	
K202173	mm	mm	mm	mm	mm	mm	#	mm	°
3/0,3	3,0	2,7	4,0	32,0	75,0	3,0	4	0,30	45
3/0,5	3,0	2,7	4,0	32,0	75,0	3,0	4	0,50	45
3/1	3,0	2,7	4,0	32,0	75,0	3,0	4	1,00	45
4/0,4	4,0	3,7	5,0	36,0	75,0	4,0	4	0,40	45
4/0,5	4,0	3,7	5,0	36,0	75,0	4,0	4	0,50	45
4/1	4,0	3,7	5,0	36,0	75,0	4,0	4	1,00	45
5/0,5	5,0	4,6	6,0	40,0	75,0	5,0	4	0,50	45
5/1	5,0	4,6	6,0	40,0	75,0	5,0	4	1,00	45
6/0,5	6,0	5,5	7,0	44,0	80,0	6,0	4	0,50	45
6/1	6,0	5,5	7,0	44,0	80,0	6,0	4	1,00	45
6/1,5	6,0	5,5	7,0	44,0	80,0	6,0	4	1,50	45

VHM Torusfräser lang TiAlN HSC | K202173

K202173	 mm ∅	 mm ∅	 mm	 mm	 mm	 mm ∅	 Z #	 R mm	 °
8/0,5	8,0	7,4	9,0	54,0	100,0	8,0	4	0,50	45
8/1	8,0	7,4	9,0	54,0	100,0	8,0	4	1,00	45
8/1,5	8,0	7,4	9,0	54,0	100,0	8,0	4	1,50	45
8/2	8,0	7,4	9,0	54,0	100,0	8,0	4	2,00	45
10/0,5	10,0	9,2	11,0	60,0	100,0	10,0	4	0,50	45
10/1	10,0	9,2	11,0	60,0	100,0	10,0	4	1,00	45
10/1,5	10,0	9,2	11,0	60,0	100,0	10,0	4	1,50	45
10/2	10,0	9,2	11,0	60,0	100,0	10,0	4	2,00	45
12/0,5	12,0	11,0	12,0	75,0	120,0	12,0	4	0,50	45
12/1	12,0	11,0	12,0	75,0	120,0	12,0	4	1,00	45
12/1,5	12,0	11,0	12,0	75,0	120,0	12,0	4	1,50	45
12/2	12,0	11,0	12,0	75,0	120,0	12,0	4	2,00	45
16/1	16,0	15,0	16,0	92,0	150,0	16,0	4	1,00	45
16/2	16,0	15,0	16,0	92,0	150,0	16,0	4	2,00	45
20/1	20,0	18,5	20,0	92,0	150,0	20,0	4	1,00	45
20/2,5	20,0	18,5	20,0	92,0	150,0	20,0	4	2,50	45