

Cooling	
Tolerance	e8
Coating	TiAlN- α

HA

HSC

UNI

Premium





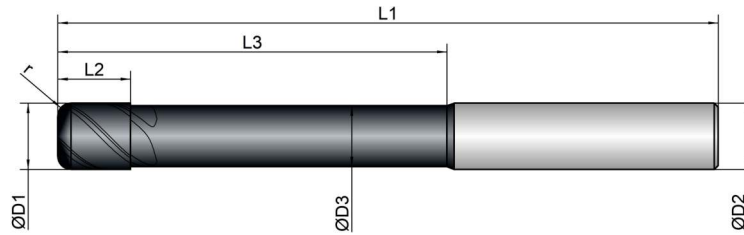





HA K202173

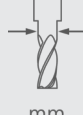

Steel			Hardened steel				Stainless steel (VA)	Castings	Non-ferrous materials				Inconel	Abrasive material		Titanium
< 850 N/mm	< 1100 N/mm	< 1400 N/mm	< 55 HRC	< 60 HRC	< 67 HRC	< 70 HRC			Al	Copper	Mg	Plastics		CFRP / GFRP	Graphite	
120	80	70	40	35			85	95								

	D1	D3	L2	L3	L1	D2	z	r	
K202173	 mm Ø	 mm Ø	 mm	 mm	 mm	 mm Ø	 #	 mm	 °
3/0,3	3.0	2.7	4.0	32.0	75.0	3.0	4	0.30	45
3/0,5	3.0	2.7	4.0	32.0	75.0	3.0	4	0.50	45
3/1	3.0	2.7	4.0	32.0	75.0	3.0	4	1.00	45
4/0,4	4.0	3.7	5.0	36.0	75.0	4.0	4	0.40	45
4/0,5	4.0	3.7	5.0	36.0	75.0	4.0	4	0.50	45
4/1	4.0	3.7	5.0	36.0	75.0	4.0	4	1.00	45
5/0,5	5.0	4.6	6.0	40.0	75.0	5.0	4	0.50	45
5/1	5.0	4.6	6.0	40.0	75.0	5.0	4	1.00	45
6/0,5	6.0	5.5	7.0	44.0	80.0	6.0	4	0.50	45
6/1	6.0	5.5	7.0	44.0	80.0	6.0	4	1.00	45
6/1,5	6.0	5.5	7.0	44.0	80.0	6.0	4	1.50	45

SC torus cutter long TiAlN HSC | K202173

K202173	 D1 mm ∅	 D3 mm ∅	 L2 mm	 L3 mm	 L1 mm	 D2 mm ∅	 z #	 r mm	 °
8/0,5	8.0	7.4	9.0	54.0	100.0	8.0	4	0.50	45
8/1	8.0	7.4	9.0	54.0	100.0	8.0	4	1.00	45
8/1,5	8.0	7.4	9.0	54.0	100.0	8.0	4	1.50	45
8/2	8.0	7.4	9.0	54.0	100.0	8.0	4	2.00	45
10/0,5	10.0	9.2	11.0	60.0	100.0	10.0	4	0.50	45
10/1	10.0	9.2	11.0	60.0	100.0	10.0	4	1.00	45
10/1,5	10.0	9.2	11.0	60.0	100.0	10.0	4	1.50	45
10/2	10.0	9.2	11.0	60.0	100.0	10.0	4	2.00	45
12/0,5	12.0	11.0	12.0	75.0	120.0	12.0	4	0.50	45
12/1	12.0	11.0	12.0	75.0	120.0	12.0	4	1.00	45
12/1,5	12.0	11.0	12.0	75.0	120.0	12.0	4	1.50	45
12/2	12.0	11.0	12.0	75.0	120.0	12.0	4	2.00	45
16/1	16.0	15.0	16.0	92.0	150.0	16.0	4	1.00	45
16/2	16.0	15.0	16.0	92.0	150.0	16.0	4	2.00	45
20/1	20.0	18.5	20.0	92.0	150.0	20.0	4	1.00	45
20/2,5	20.0	18.5	20.0	92.0	150.0	20.0	4	2.50	45