

Kühlung	
Toleranz	h9
Beschichtung	TiSiN- α

HA

HSC

UNI

NEW

Expert

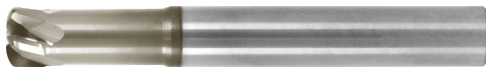

HA K207003

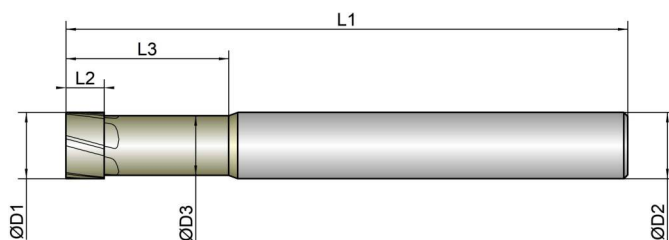

Stahl			Gehärteter Stahl				INOX (VA)	Guss	NE-Werkstoffe				Inconel	Abrasive material		Titan
< 850 N/mm	< 1100 N/mm	< 1400 N/mm	< 55 HRC	< 60 HRC	< 67 HRC	< 70 HRC			Alu	Kupfer	Mg	Kunststoffe		CFK / GFK	Grafit	
150	145	135					100									

K207003	D1 mm ø	D3 mm ø	L2 mm	L3 mm	L1 mm	D2 mm ø	z #	 mm	 mm max	 °
2	2,0	1,7	1,5	13,0	54,0	6,0	2	0,3	0,15	15
3	3,0	2,7	1,5	15,0	54,0	6,0	2	0,3	0,20	15
4	4,0	3,6	2,5	16,0	57,0	6,0	2	0,5	0,25	15
5	5,0	4,6	3,5	18,0	65,0	6,0	4	0,5	0,35	15
6	6,0	5,2	3,5	20,0	65,0	6,0	4	1,0	0,40	15
8	8,0	7,0	4,8	24,0	70,0	8,0	5	1,5	0,50	15
10	10,0	9,0	5,8	26,0	85,0	10,0	5	2,0	0,75	15
12	12,0	11,0	6,8	30,0	93,0	12,0	5	2,0	0,80	15
16	16,0	14,5	8,8	35,0	100,0	16,0	5	2,5	1,00	15